



# RePlant System Drill Sequence

## 3.5mmD RePlant Straight / Tapered Implant



SD2.3  
2.3/2.0mmD

Soft Bone Final



RSB3  
2.8/2.3mmD

Dense Bone Final



RDB3  
3.2mmD

## 4.3mmD Straight / Tapered Implant



SD2.3  
2.3/2.0mmD

Optional



RSB3  
2.8/2.3mmD

Soft Bone Final

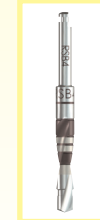

RSB4  
3.4/2.8mmD

Dense Bone Final

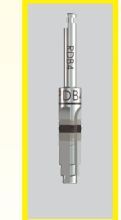

RDB4  
4.0mmD

## 5.0mmD Straight / Tapered Implant

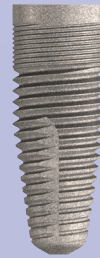
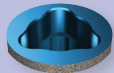

SD2.3  
2.3/2.0mmD

Optional



RSB3  
2.8/2.3mmD



RSB4  
3.4/2.8mmD

Soft Bone Final



RSB5  
4.2/3.3mmD

Dense Bone Final



RDB5  
4.7mmD

## 6.0mmD Straight / Tapered Implant

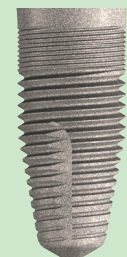
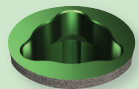

SD2.3  
2.3/2.0mmD

Optional



RSB3  
2.8/2.3mmD



RSB4  
3.4/2.8mmD

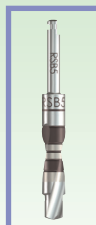

RSB5  
4.2/3.3mmD

Soft Bone Final



RSB6  
5.1/4.2mmD

Dense Bone Final

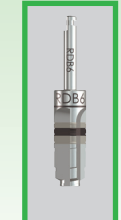

RDB6  
5.7mmD

